

HANGING BANNERS

HANGING BANNER
10 FT. CIRCLE 42 IN. SINGLE-SIDED
PRODUCT CODE: SP-10-HANG-R



INSTRUCTIONS

1

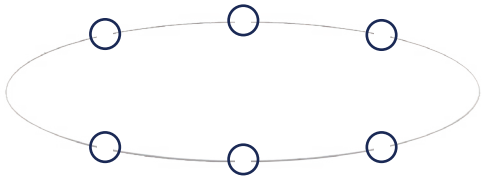
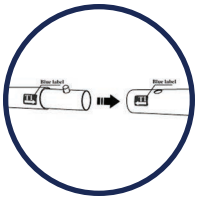

- See colored numbers on each tube piece. Match colored numbers together. (e.g. T1 - T1, T2 - T2).

2

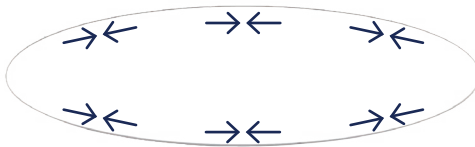
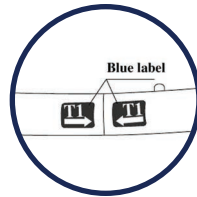

- First connect the top curve horizontal tubes (Blue Colored Label: T) and snap them together.

3

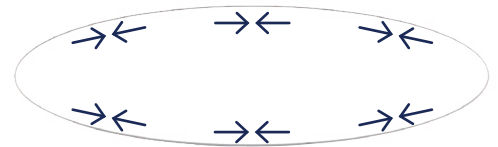

- Then connect the bottom curve horizontal tubes (Blue Colored Label: B) and snap them together.

4

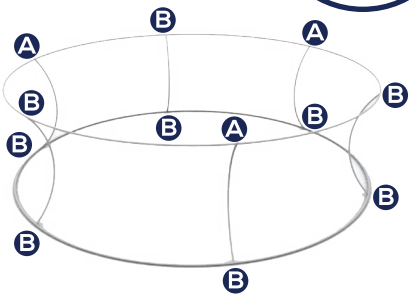
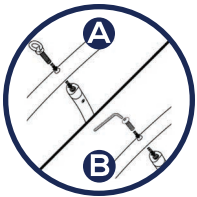

- Locate each screw holes on the sides of the top and bottom tubes. Align the vertical curve tubes within the screw holes at each end. Make sure the middle tubes are bowing inward. Insert eyehook (A) and large screws (B) into the top and bottom screw holes. Tighten to secure.

5

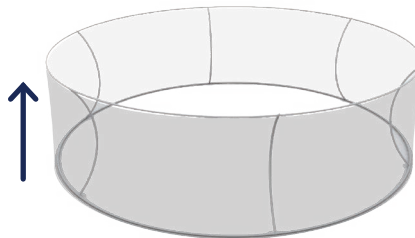
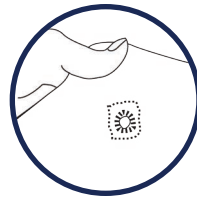

- Place the graphic underneath the frame. Pull up the graphic and cover the entire frame. Make sure the printed graphic faces outwards and the pre-hemmed holes are aligned with the top screws. Insert the eyehooks along the pre-hemmed holes.

6



- Using the industrial-size zipper, zip above the top tube, maximizing fabric tension. And zip to closed.

NOTE: To suspend hanging banner, professional rigging services are recommended and may be required at most sites.